

Nosso produtos são garantidos por 90 dias contra defeitos de fabricação. Ao constatar um problema coberto pela garantia, entre em contato com a loja onde o produto foi comprado. Ela estará capacitada para atendê-lo da melhor forma diante de cada caso. Reclamações de garantia somente poderão ser atendidas se o termo de garantia for apresentado no ato de reivindicação, acompanhado de sua nota fiscal de compra.

Nuestros productos están garantidos contra defectos de fabricación por 90 días, a partir de la compra. Ao constatar un problema protegido por la garantía, póngase en contacto con la tienda donde se adquirió el producto. Ella estará capacitada para atenderlo de la major manera de acuerdo con cada caso.

Our products are guaranteed against manufacturing defects for 90 days from the date of purchase. When you find a problem covered by the warranty, please contact the store where the product was purchased. The store be able to serve you in the best way in each case.

Exclusões:

Desgaste natural ou danos causados por água, maresia, ferrugem, incêndio, calor, cupins e pragas em geral. Montagem, manutenção e uso inadequado. Não cumprimento das recomendações técnicas do esquema. Montagens e desmontagens após a primeira instalação. Instalações elétricas e outras afins.

Exclusões:

Desgaste natural o daños causados por agua, niebla salina, óxido, fuego, calor, termitas y plagas en general. Mantenimiento y uso inadecuado. Incumplimiento de las recomendaciones técnicas del esquema. Montaje y desmontaje tras la primera instalación. Instalaciones eléctricas y otras similares.

Exclusões:

Natural wear and tear or damage caused by water, sea spray, rust, fire, heat, termites and pests in general. Improper assembly, maintenance and use. Failure to comply with the technical recommendations of the scheme. Assembly and disassembly after the first installation. Electrical and other related installations.

Importante

A Linea Brasil não autoriza nenhuma pessoa, loja ou entidade assumir em seu nome qualquer outra garantia que não conste no certificado. A fabricante reserva-se no direito de efetuar nos produtos eventuais modificações que considerar necessárias, sem prejudicar as características essenciais. Os produtos terão peças de assistência para reposição no período de 1 ano a contar de sua retirada do mercado, desde que haja matéria-prima equivalente, observando o dispositivo no Art.32 da Lei 8.078/90 (Cód. Defesa do Consumidor). O atendimento para produtos fora de linha é feito por programação especial, através da loja revendedora sob aprovação de consulta prévia ao fabricante.

Importante

Linea Brasil no autoriza a ninguna persona, tienda o entidad a asumir en su nombre cualquier otra garantía que no figure en el certificado. El fabricante se reserva el derecho de efectuar en los productos eventuales modificaciones que considere necesarias, sin perjudicar las características esenciales. Los productos tendrán piezas de asistencia para reposición en el período de 1 año a partir de su retirada del mercado. La atención para productos fuera de línea es hecha por programación especial, a través de la tienda revendedora bajo aprobación de consulta previa al fabricante.

Importante

Linea Brasil does not authorize any person, store or entity to assume on its behalf any other warranty that does not appear on the certificate. The manufacturer reserves the right to make in the products any modifications that it considers necessary without prejudice to the essential characteristics. The products will have replacement parts within one year of being withdrawn from the market. The service for off-line products is done by special programming, through the store reseller under prior consultation with the manufacturer.

Para retirar o pó, utilize um pano seco, espanador ou aspirador. Se necessário, para uma limpeza mais efetiva, utilize um pano levemente umedecido com água. Finalize com uma flanela limpa e seca. Evite materiais abrasivos, umidade e calor.

Para quitar el polvo, utilice un paño seco, un plumero o una aspiradora. Si es necesario, para una limpieza más eficaz, utilice un paño ligeramente humedecido con agua. Termine con una flanela limpia y seca. Evite materiales abrasivos, humedad y calor.

To remove dust, use a dry cloth, duster or vacuum cleaner. If necessary, for more effective cleaning, use a cloth slightly dampened with water. Finish with a clean, dry flannel. Avoid abrasive materials, humidity and heat.

VOLUME	ITEM	PEÇA	DESCRIÇÃO	DIMENSÕES (mm)			QUANTIDADE
Caja	Artículo	Pieza	Descripción	Dimensión	Cantidad	Material	
BOX	Item	Part	Description	Dimension	Amount		
1	1	S10232001	TAMPO Base Base	391	298	18	1 MDF
1	2	S10232002	LATERAL DIREITA LATERAL DERECHA RIGHT SIDE	384	295	18	1 MDF
1	3	S10232003	LATERAL ESQUERDA LATERAL IZQUIERDA LEFT SIDE	384	295	18	1 MDF
1	4	S10232004	PRATELEIRA REPISA SHELF	350	278	15	1 MDP
1	5	S10232005	BASE TAPA BASE	391	298	18	1 MDF
1	6	S10232006	FUNDO INFERIOR/SUPERIOR INFERIOR/SUPERIOR INFERIOR LOWER/UPPER BOTTOM	376	206	3	2 MDF
1	8	S10232008	FRENTE DE GAVETA FRENTE DE CAJÓN DRAWER FRONT	346	198	15	1 MDP
1	9	S10232009	LATERAL ESQUERDA GAVETA CAJÓN LADO IZQUIERDO DRAWER LEFT SIDE	252	150	15	1 MDP
1	10	S10232010	LATERAL DIREITA GAVETA CAJÓN LADO DERECHO DRAWER RIGHT SIDE	252	150	15	1 MDP
1	11	S10232011	FUNDO GAVETA FONDO DEL CAJÓN DRAWER BOTTOM	305	243	3	1 MDF
1	12	S10232012	CONTRA FUNDO GAVETA FONDO DEL CAJÓN DRAWER BOTTOM	295	148	15	1 MDP

TABELA DE ACESSÓRIOS TABLA DE ACCESORIOS ACCESSORIES TABLE			
Código Code	Descrição Description Description	Quantidade Amount	
A 160001002	PRENDEDOR DE FUNDOS CLIP DE FONDO FUNCTIONAL CLAMP	3	
B 160001023	CAVILHA 6X30MM PASADOR 6X30MM 6X30MM DOWEL	12	
C 160001024	PINO GIROFIX PIN GIRLOFIX GIROFIX PIN	18	
D 160001025	CASTANHA DO MINI-GIROFIX MINI-GIROFIX CASTAÑO MINI-GIROFIX NUTS	18	
E 160002002	TAMPA ADESIVA 18MM CUBIERTA ADHESIVA 18MM 18MM ADHESIVE COVER	8	
F 160002015	BATENTE SILICONE TAPÓN DE SILICONA SILICONE STOPPER	2	
G 160005055	PUXADOR EM COURO MANGO DE CUERO LEATHER HANDLE	1	
H 160005056	BOTAO PARA PUXADOR DE COURO BOTÓN CON ASA DE CUERO LEATHER HANDLE KNOB	1	
I 160006001	PARAFUSO 3,5X12 CABECA CHATA TORNILLO DE CABEZA PLANA 3.5X12 3.5X12 FLAT HEAD SCREW	12	
J 160006011	PREGO CLAVO NAIL	24	
K 160006020	PINO UNIAO M4 12MM PASADOR DE UNION M4 12 MM 12MM M4 UNION PIN	1	
L 160006022	PARAFUSO M4 12MM CHATA TORNILLO PLANO M4 12MM 12MM M4 FLAT SCREW	1	
M 160006053	PARAFUSO ESTRUTURAL TORNILLO ESTRUCTURAL STRUCTURAL SCREW	4	
N 160008005	CORREDICA DESLIZAR SLIDE	1	
O 160009031	PE CONICO MADEIRA PE CONICO DE MADERA WOOD CONICAL PE	4	

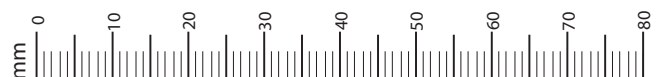

01

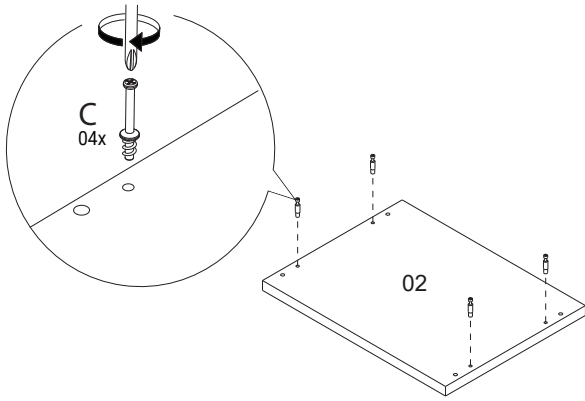

02

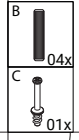
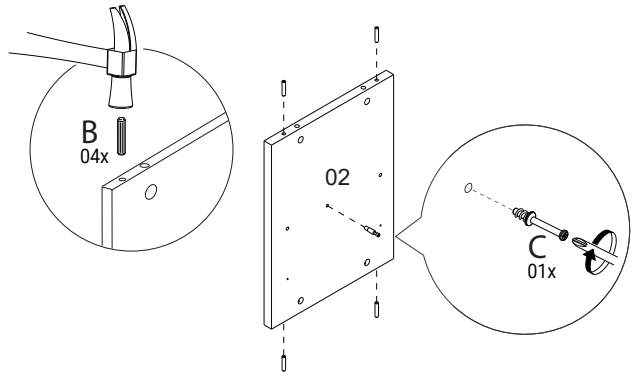

03

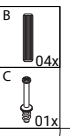
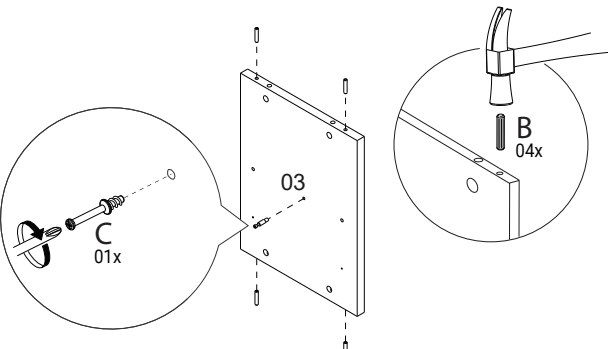

04

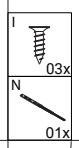
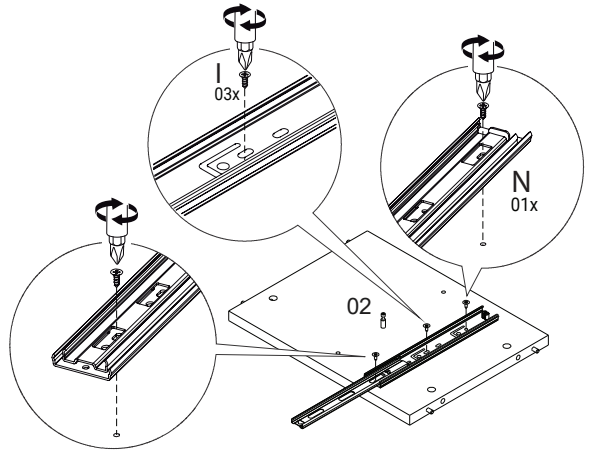

05

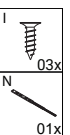
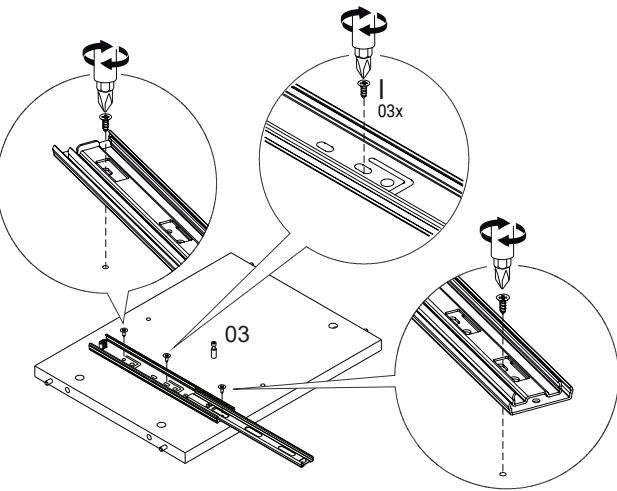

06

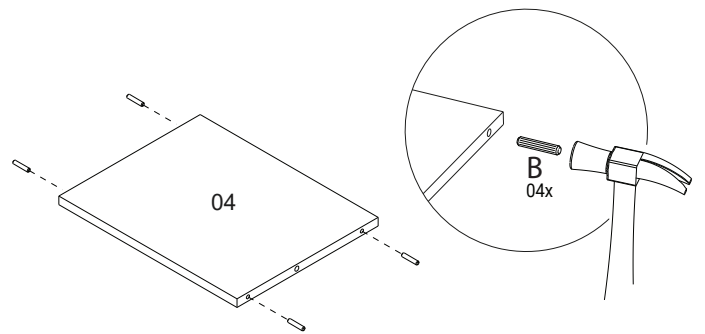

07

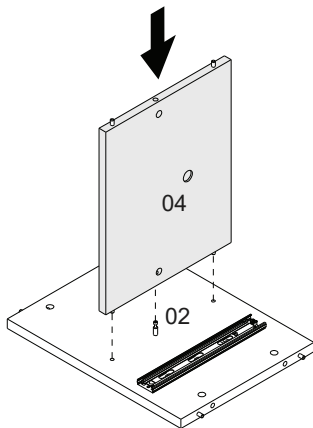

08

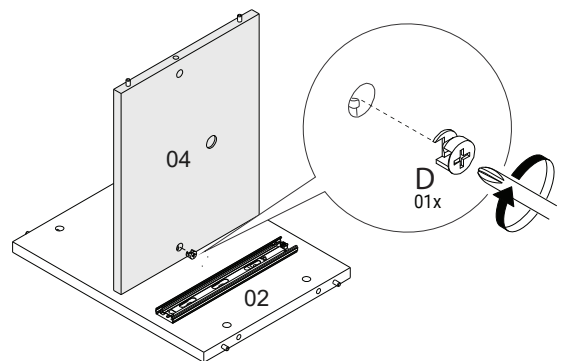

09

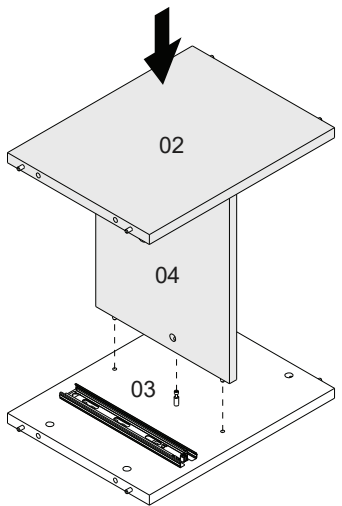

10

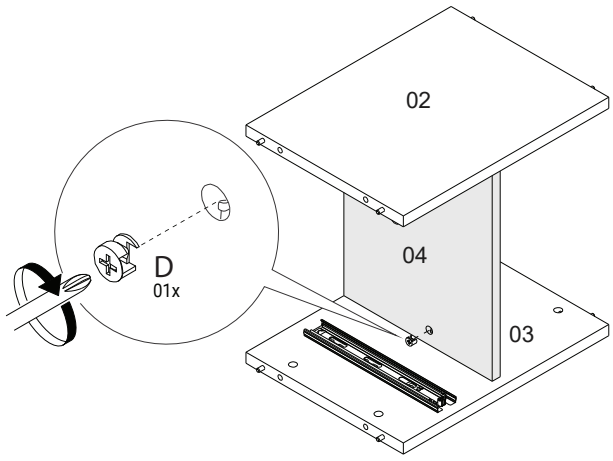

11

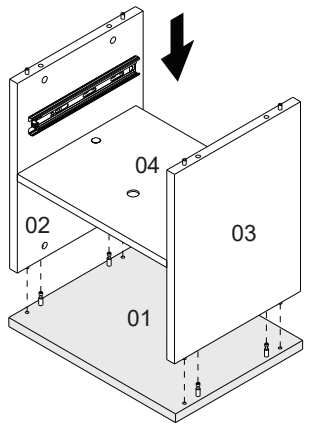

12

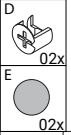
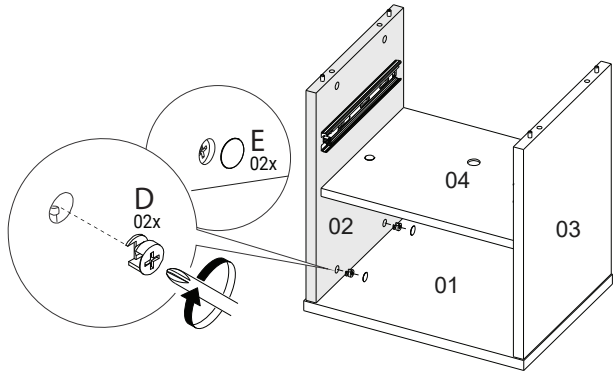

13

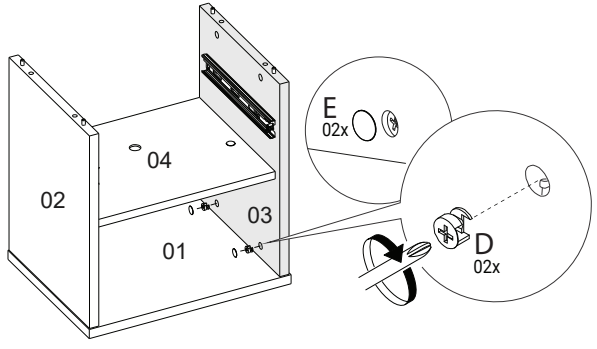

14

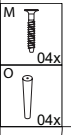
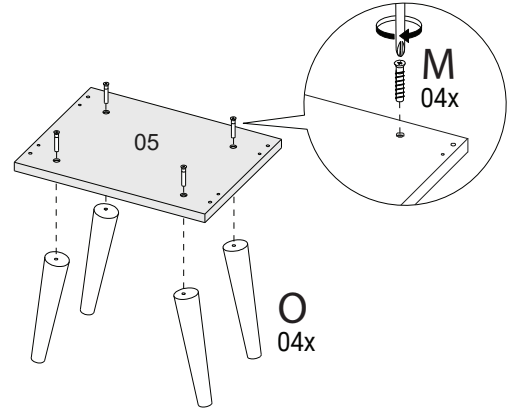

15

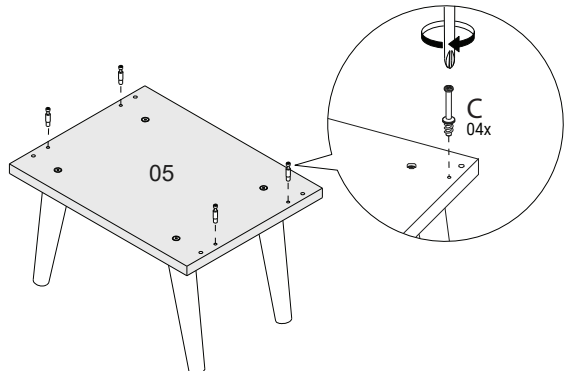

16

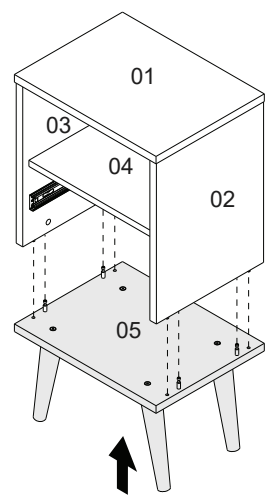

17

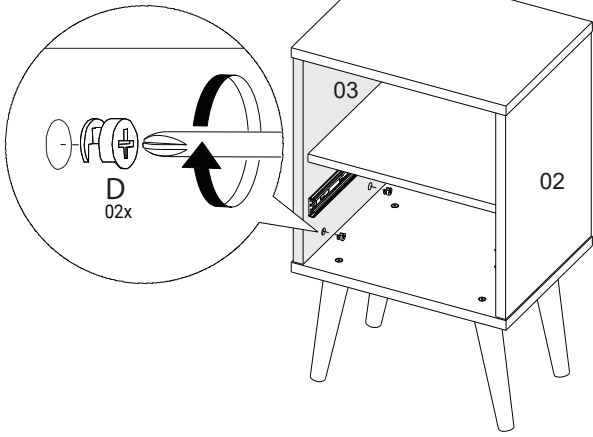

18

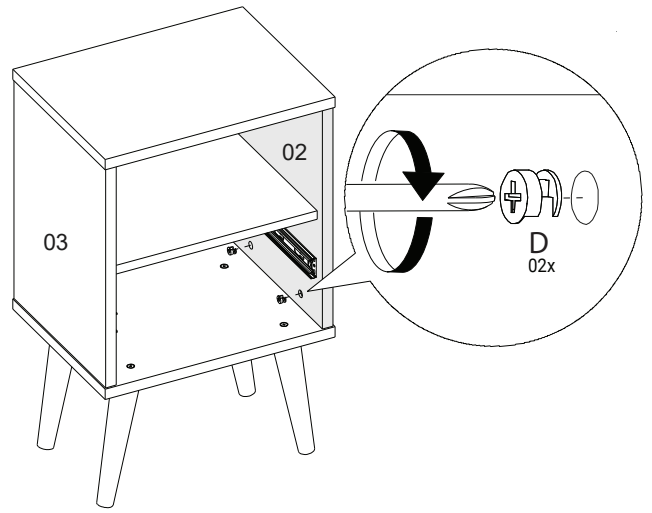

19

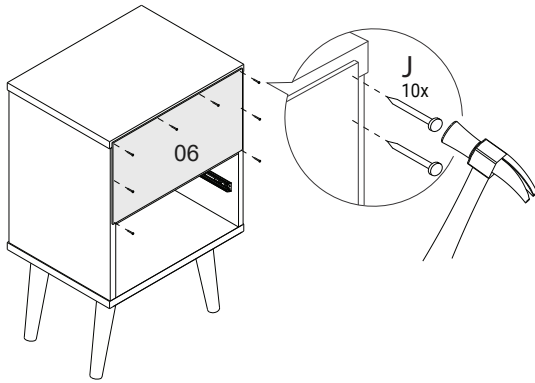

20

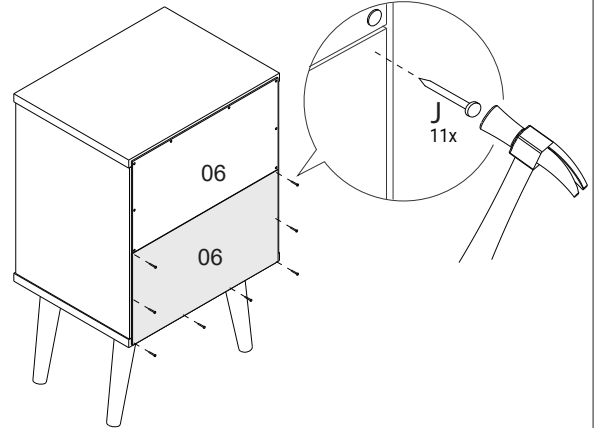

21

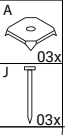
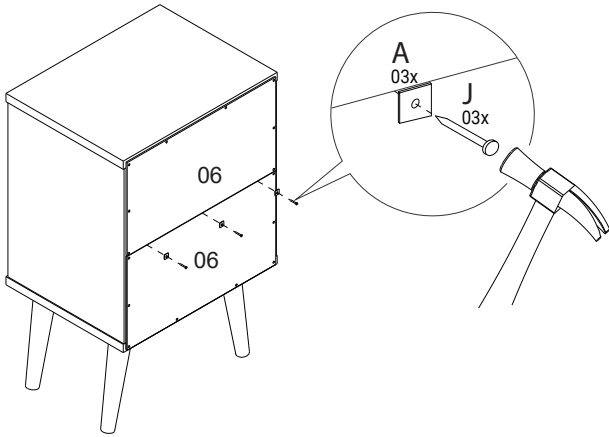

22

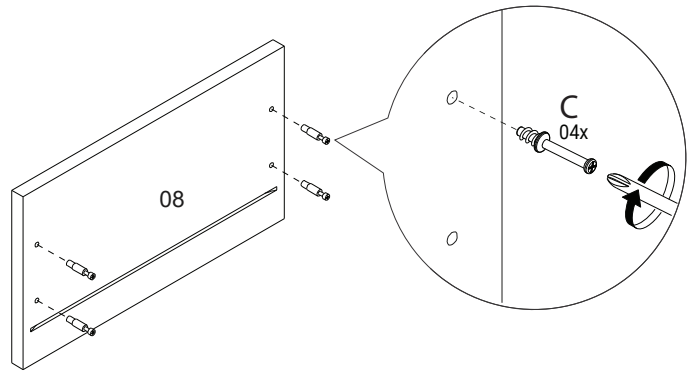

23

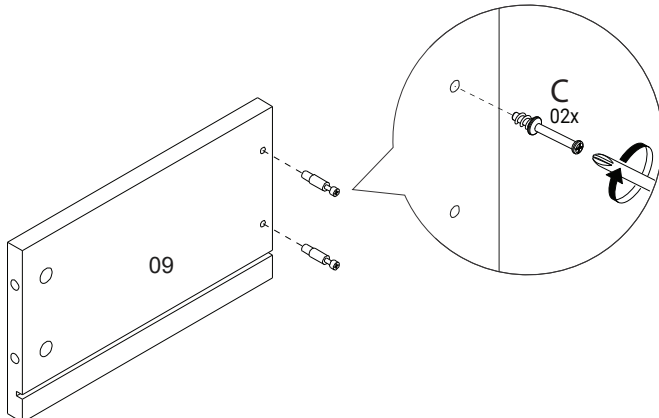

24

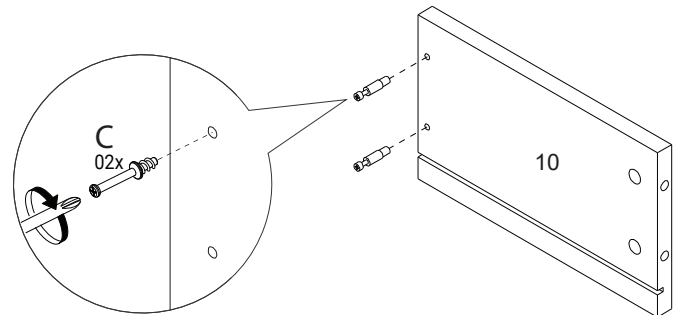

25

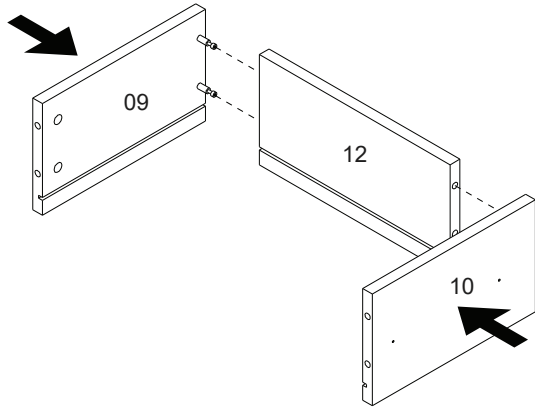

26

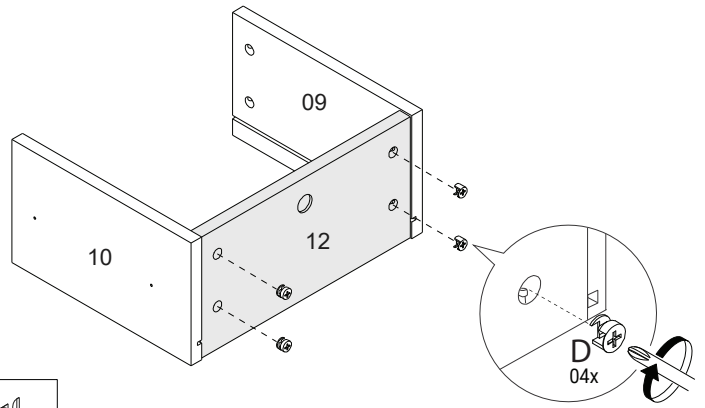

27

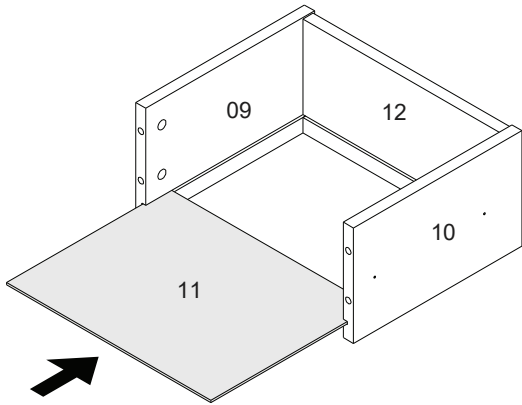

28

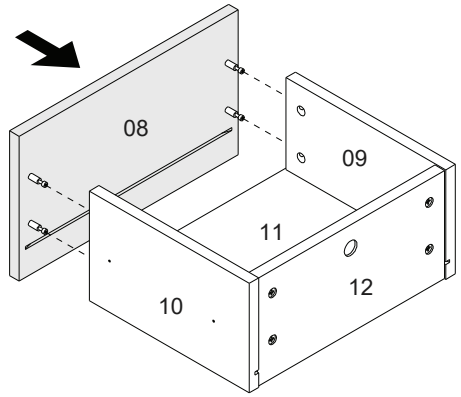

29

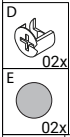
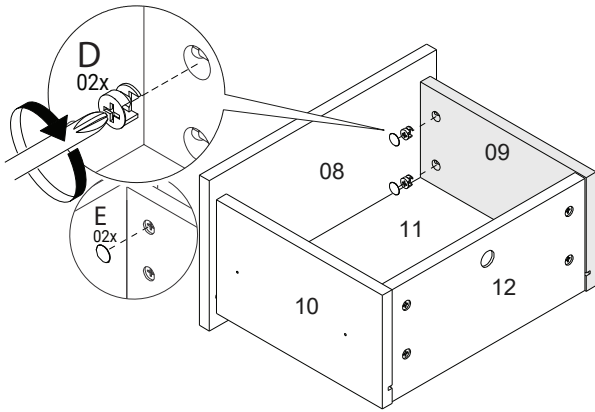

30

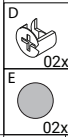
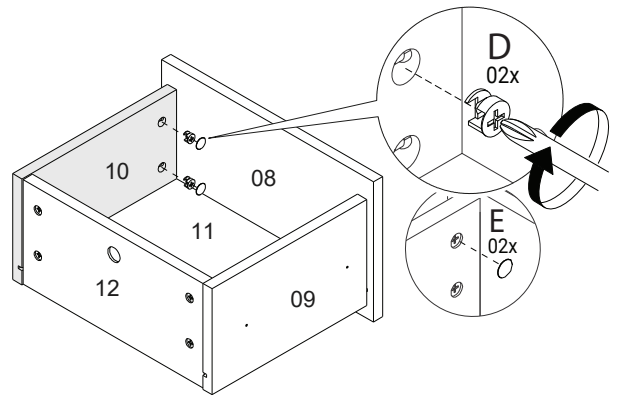

31

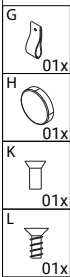
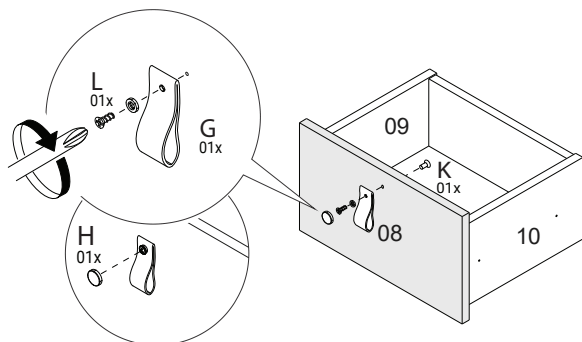

32

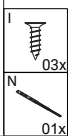
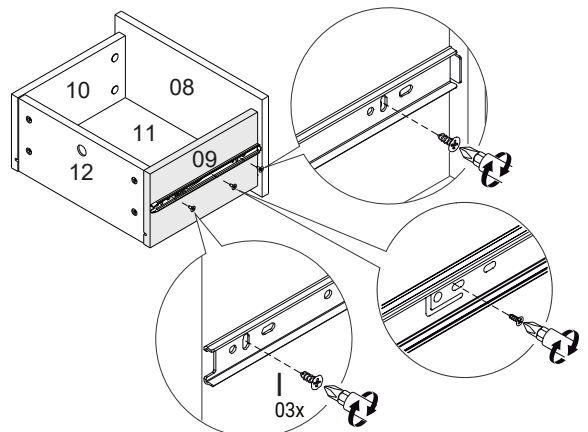

33

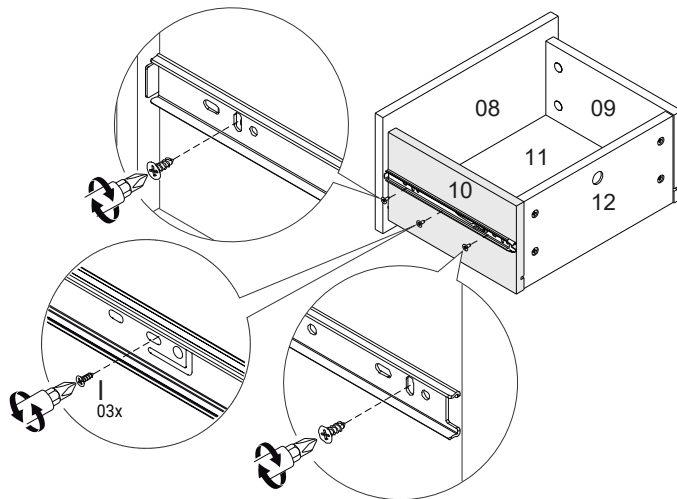

34

